

PROPOSED EAST ELEVATION

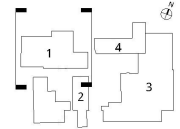

THIS COPY HAS BEEN MADE BY OR WITH THE AUTHORITY OF RYEDALE DISTRICT COUNCIL PURSUANT TO SECTION 47 OF THE COPYRIGHT DESIGNS AND PATENTS ACT 1988. UNLESS THAT ACT PROVIDES A RELEVANT EXCEPTION TO COPYRIGHT, THE COPY MUST NOT BE COPIED WITHOUT THE PRIOR PERMISSION OF THE COPYRIGHT OWNER.

Date valid 09/01/20



PROPOSED WEST ELEVATION

DO NOT SCALE FROM THE DRAWING. All dimensions shall be taken from the finished building. All dimensions shall be taken from the finished building. All dimensions shall be taken from the finished building.

Copyright Artform Architects

Rev	Description	Date	By
01	Amendments to floor levels and food down added	08.01.20	JE

NOTE: All existing brickwork, roofing, plaster, glazed and building fabric to be cleaned, repaired and replaced as necessary with structural work carried out in accordance with recommendations set out in JEM's Structural Inspection Report.

Scale	Drawn	Date
1:100	BA3	12/09/19
1:100	BA3	12/09/19
1:100	BA3	12/09/19

WEB: www.artformarchitects.co.uk | EMAIL: info@artformarchitects.co.uk
WeWork No.1 Spinningfields Quay Street Manchester | TEL: 0161 6603377

BRIDGE HOUSE FARM
Proposed Block 1 East & West Elevation
ARTFORM
ARCHITECTS